

REV.	DESCRIPTION	REVISER	DATE
V0	NEW	Coco	2024.06.05

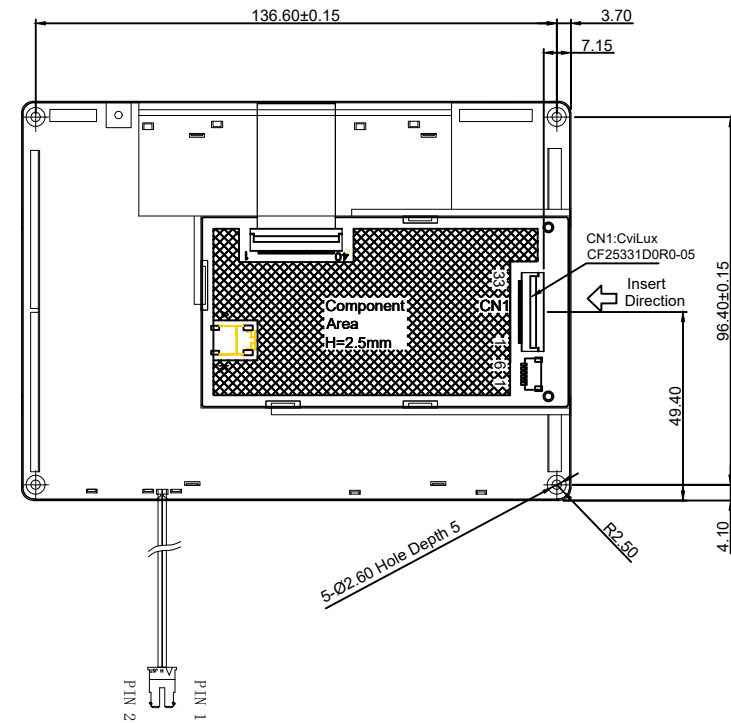

CN1

PIN NO	SYMBOL
1	Vss
2	CLK
3	IHS
4	IVS
5	Vss
6	R0
7	R1
8	R2
9	R3
10	R4
11	R5
12	Vss
13	G0
14	G1
15	G2
16	G3
17	G4
18	G5
19	Vss
20	B0
21	B1
22	B2
23	B3
24	B4
25	B5
26	Vss
27	DEN
28	Vcc
29	Vcc
30	R/L
31	U/D
32	NC
33	Vss

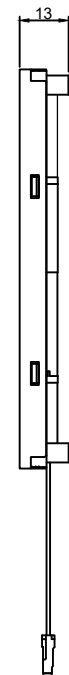
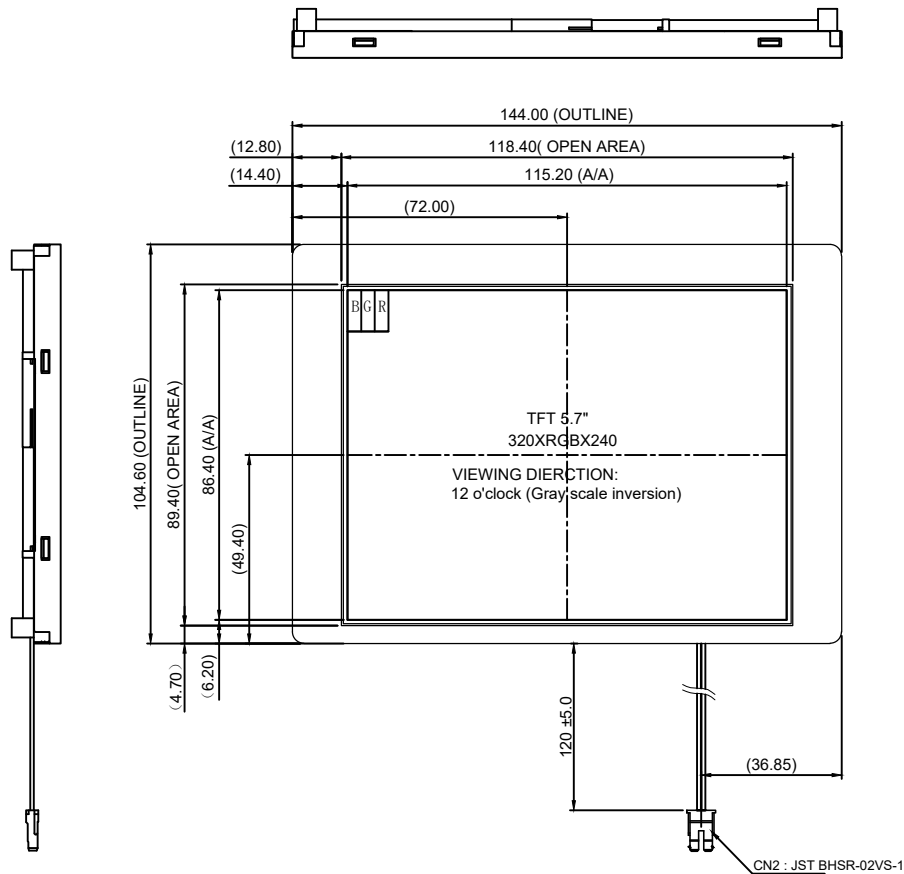
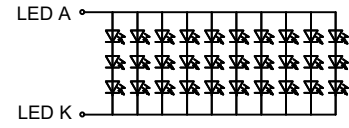

BLU Circuit: 3S-10P BLU VF=9.6V(Typ), IF=200mA

CN2

PIN NO	SYMBOL
1	LEDA
2	LEDK

- NOTES:
- DISPLAY TYPE: 7.0" TN TFT, TRANSMISSIVE, Normally White
 - VIEWING DIRECTION: 12 o'clock (Gray scale inversion)
U/D/L/R: 60/50/60/60
 - OPERATING TEMP: -20°C~+70°C
 - STORAGE TEMP: -30°C~+80°C
 - Luminance: 650min, 700 Typ cd/m²
 - UNMARKER TOLERANCE: ±0.3
 - REQUIREMENTS ON ENVIRONMENTAL PROTECTION: RoHS

Kingtech Group Co., Ltd.

Unspecified Tolerance:	±0.3	UNITS: mm	DATE:	MODEL NUMBER :		SHEET:	1 Of 1
DESIGN BY:	Coco	2024.06.05	MODEL NUMBER :	PV05715Y0133R	PROJECTION	DRAWING	LCM
CHECKED BY:						DESCRITUON:	
APPROVED BY:							